

Coming Soon...

From Belden®...the company known for its dedication to the development of high performance, high density networking connectivity

The New Belden High Density Open Frame Enclosure

To answer the needs of today's world class data center, Belden will soon release a High Density Open Frame Enclosure that is the perfect host for dense cross-connect fields, large servers, switches and routers, while simultaneously offering unprecedented cable management and cooling features:

- The enclosure's open frame design enables easy access to the equipment and cables inside since there's no outside post to obstruct installer access
- Corrugated front and rear doors (resulting in an 80%+ opening) to optimize air flow

- The enclosure's footprint has been optimized to enable the mounting of deep equipment
- Multiple cable access options (top and bottom), combined with superior cable management options; built-in channels (with fingers), front and rear cable management channels, front-to-rear routing channel options and various power distribution mounting options

For more exciting details on this new Belden product, see the captioned illustration on the next page.



Left: An optimized footprint (30" W x 43" D x 84" H) enables the use of deep equipment. The enclosure is also rated at 2,000 lbs.

Above: Corrugated front and rear doors optimize air flow.

High Density Open Frame Enclosure

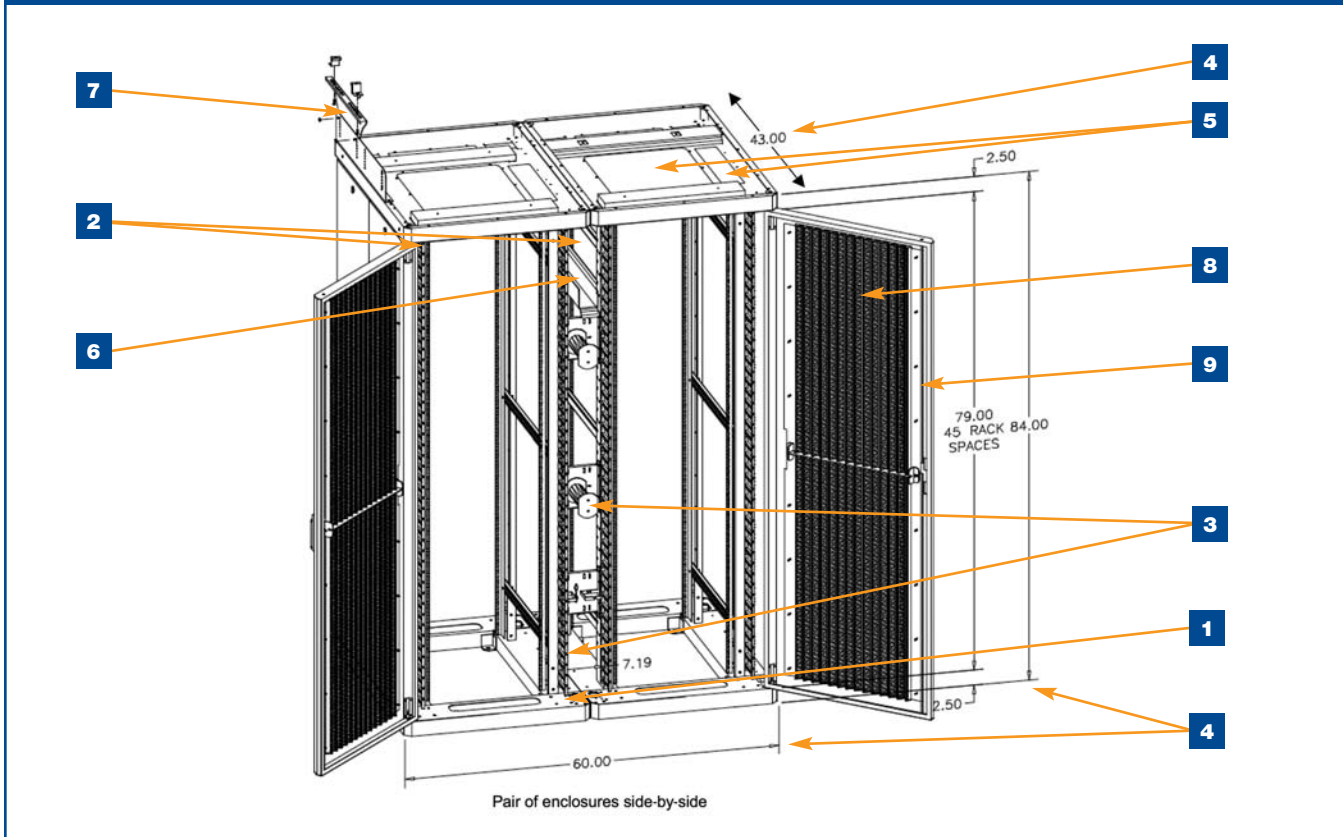

Cable management and density-enabling features

1. Easy access to the equipment and cables is provided; this enclosure does not have the outside post that is found in most standard enclosures.
2. When ganged together, a 7-inch wide cable manager channel is created to facilitate cabling routing. When the side panels are used, a 2-3/4-inch cable management channel is available.
3. Unit includes built-in front and rear cabling management channels with optional 1RU-spaced bend radius cable management fingers and slack management spools.
4. An optimized footprint (30" wide x 43" deep x 84" high) that is compliant with the TIA-942 recommendation and enables the use of deep networking equipment (up to 28.6" deep). The enclosure is also rated at 2,000 lbs.

5. Multiple cable access options – on the top (knock-outs are provided so you can provide opening only where needed) and the bottom.
6. Front-to-rear channel routing options with rounded edges.
7. Optional ladder rack mounting bracket.

Cooling features

Designed to reduce air flow obstruction and let the "hot" and "cold" aisles concept work at its best:

8. Corrugated front and rear doors to increase the surface of the door and its rigidity. The resulting perforation pattern provides an air flow opening of 80%+ (TIA-942 recommends a minimum of 50%).
9. The door frame design ensures air flow throughout the enclosure – and the rear door can be equipped with high capacity (CFM) fans when forced air is required.

General features

- When the doors are closed, the cable management channels are hidden, enhancing the look of the install.
- Optional Zone 4 seismic rated version.
- The doors are reversible; they are spring-loaded to quickly change the door swing.
- Flush surface lock fasteners permit quick disconnect and lift off of the sides.
- The doors and side panels lock for security purposes and the door handles are flush-mounted.
- A grounding kit is offered, as well as high strength leveling feet and casters.
- Various power distribution mounting options.

This extraordinary enclosure will soon enter production so be sure to contact your local Belden rep for more information.