

Installation Guide

10GX IDC X-Conn. Multiple Frames Installation



PX105226-EN Release B

Page 1/10

A) General

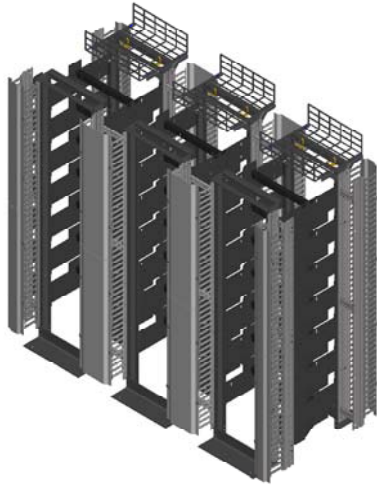

Related Documents:

- IS-8_BELDEN_V1:
Belden Cable Manager Installation Instructions
- PX104781
10GX IDC Patch Panel
- PX105081
10GX IDC Connecting Block Termination Procedure
- PX105224
10GX IDC X-Conn. Front-to-Back Cross-Conn. Cable Management Trough Kit
- PX105225
10GX IDC X-Conn. Horizontal Cross-Conn. Cable Management Tray Kit
- TELIS00-2BEL
Two Post Self-Supporting Equipment Rack Assembly Instruction

Components

Standard components

- 1- BHHR194 - Two Post Self Supporting Rack
- 2- AX104225 - Front-to-Back Trough Kit 42"
- 3- BHVH006 - 6" Vertical Manager
- 4- BHVH012 - 12" Vertical Manager

Optionnal components

- 5- AX104225-S Front-to-Back Trough Kit 38"
- 6- AX104226 - Overhead Kit

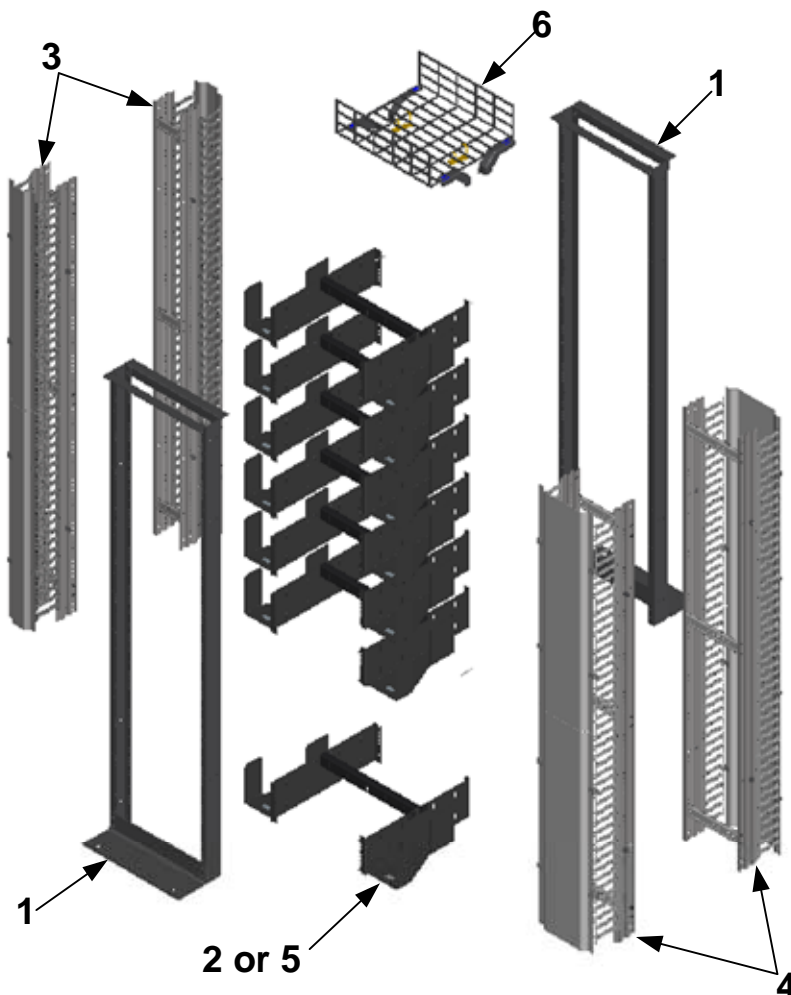

B) Floor Layout

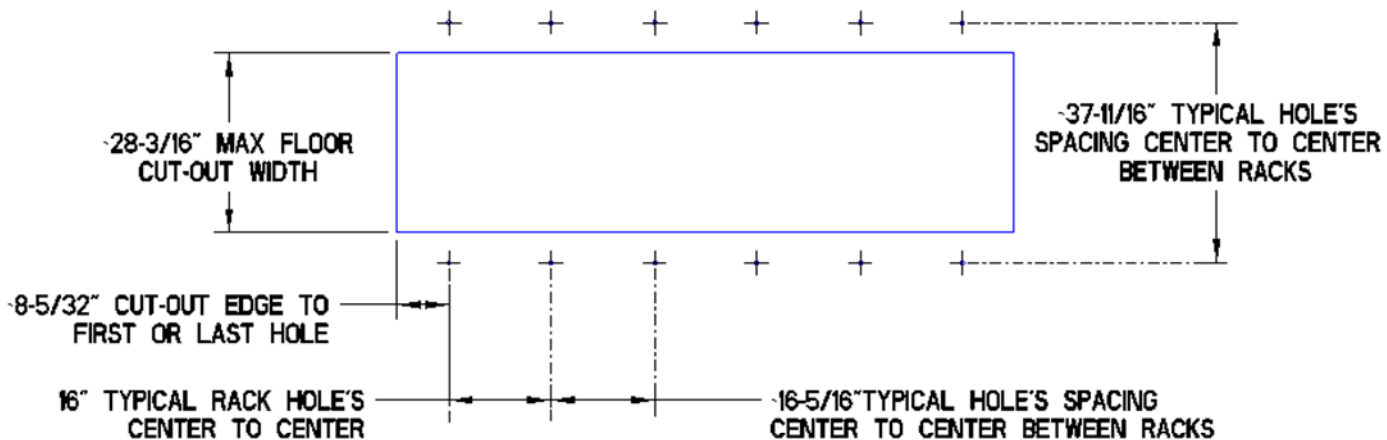

C) Installation

Step 1:

- Install first rack with a co-worker (refer to PX105224 for 10GX IDC X-Conn. Front-to-Back Cross-conn. Cable Management Trough Kit)

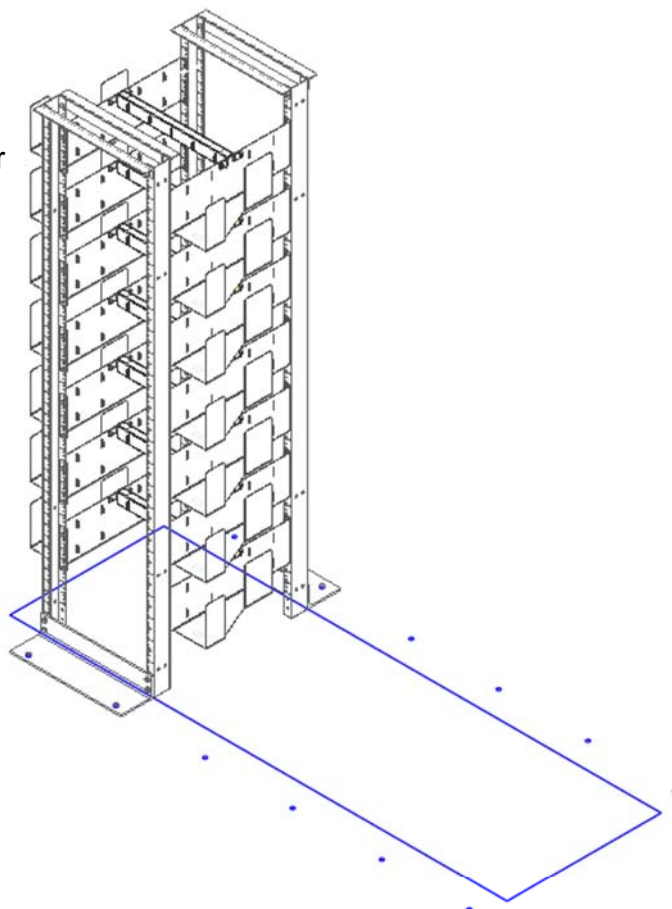

Step 2:

- Install end 6" vertical manager
- Refer to IS-8_BELDEN_V1: Belden Cable Manager Installation Instructions

6" vertical manager

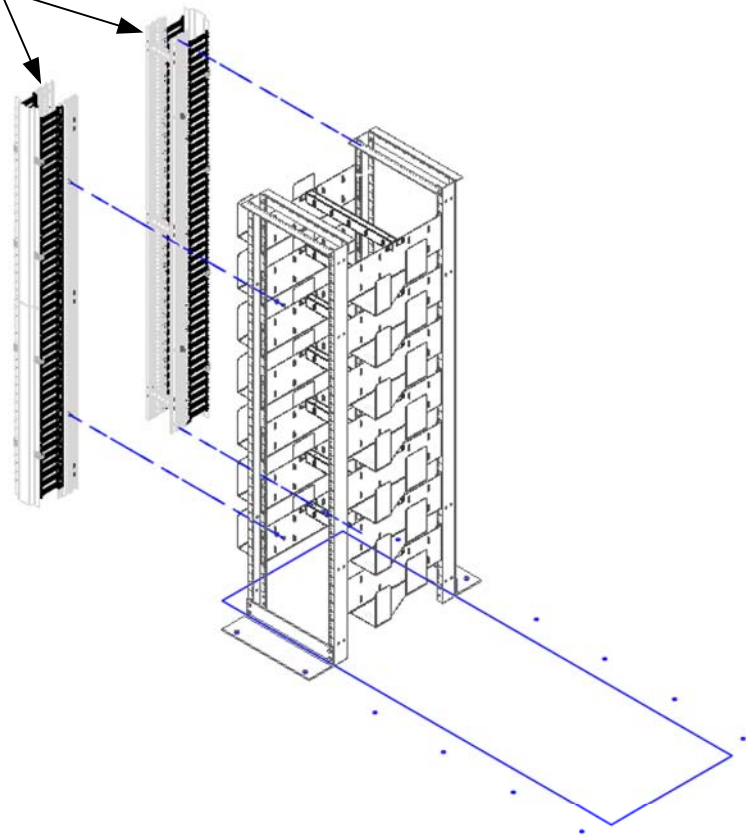
**Step 3:**

- Install center 12" vertical manager
- Refer to IS-8_BELDEN_V1: Belden Cable Manager Installation Instructions

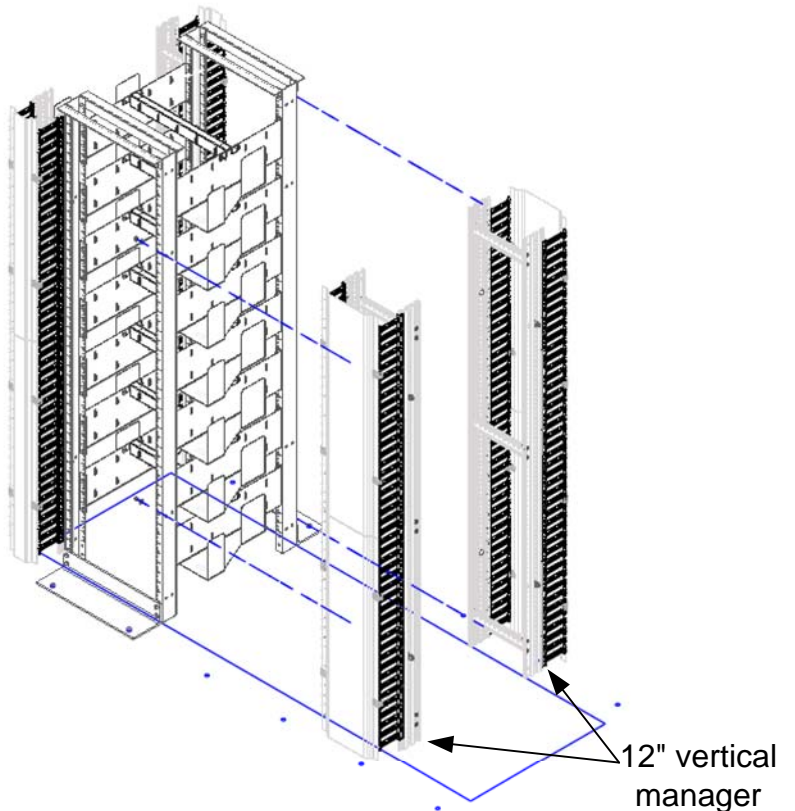

Step 4:

- Install as many frames (Step-1) and 12" vertical manager (Step-3) with a co-worker
- Refer to IS-8_BELDEN_V1: Belden Cable Manager Installation Instructions and PX105224 10GX IDC X-Conn. Front-to-Back Cross-Conn. Cable Management Trough Kit

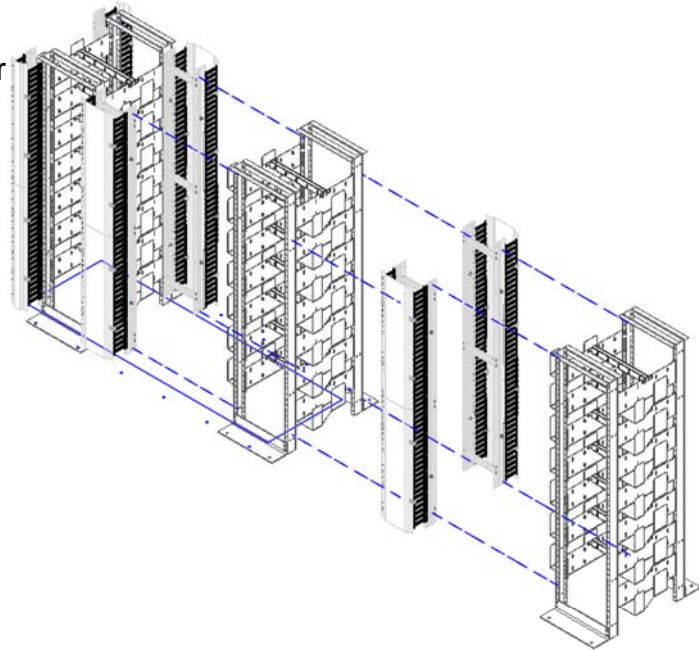

Step 5:

- Install end 6" vertical manager
- Refer to IS-8_BELDEN_V1: Belden Cable Manager Installation Instructions

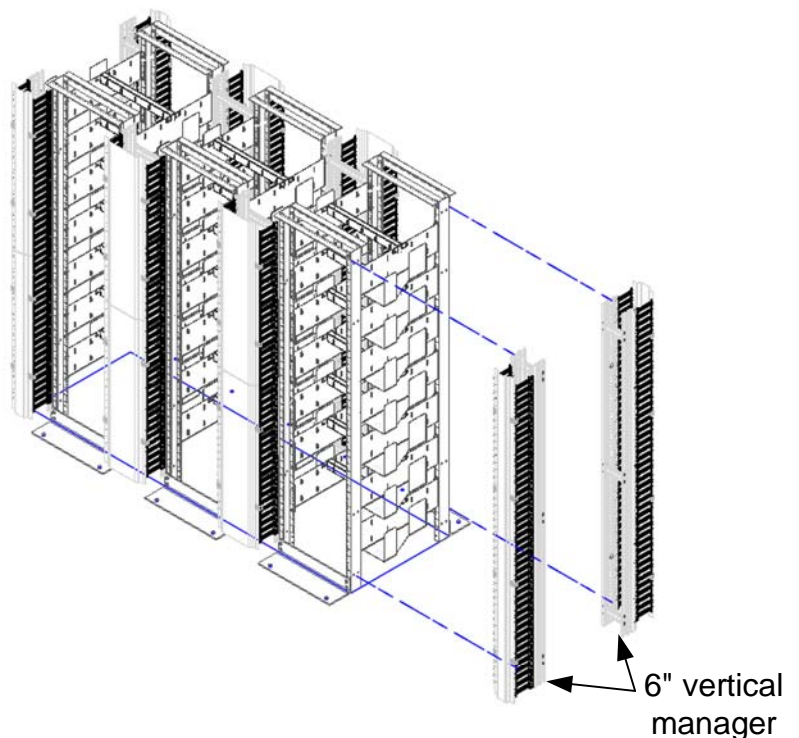

Step 6:

- Install optional 10GX IDC X-Conn. Horizontal Cross-Conn. Cable Management Tray Kit (AX104226)
- Refer to PX105225 10GX IDC X-Conn. Horizontal Cross-Conn. Cable Management Tray Kit Installation Instructions

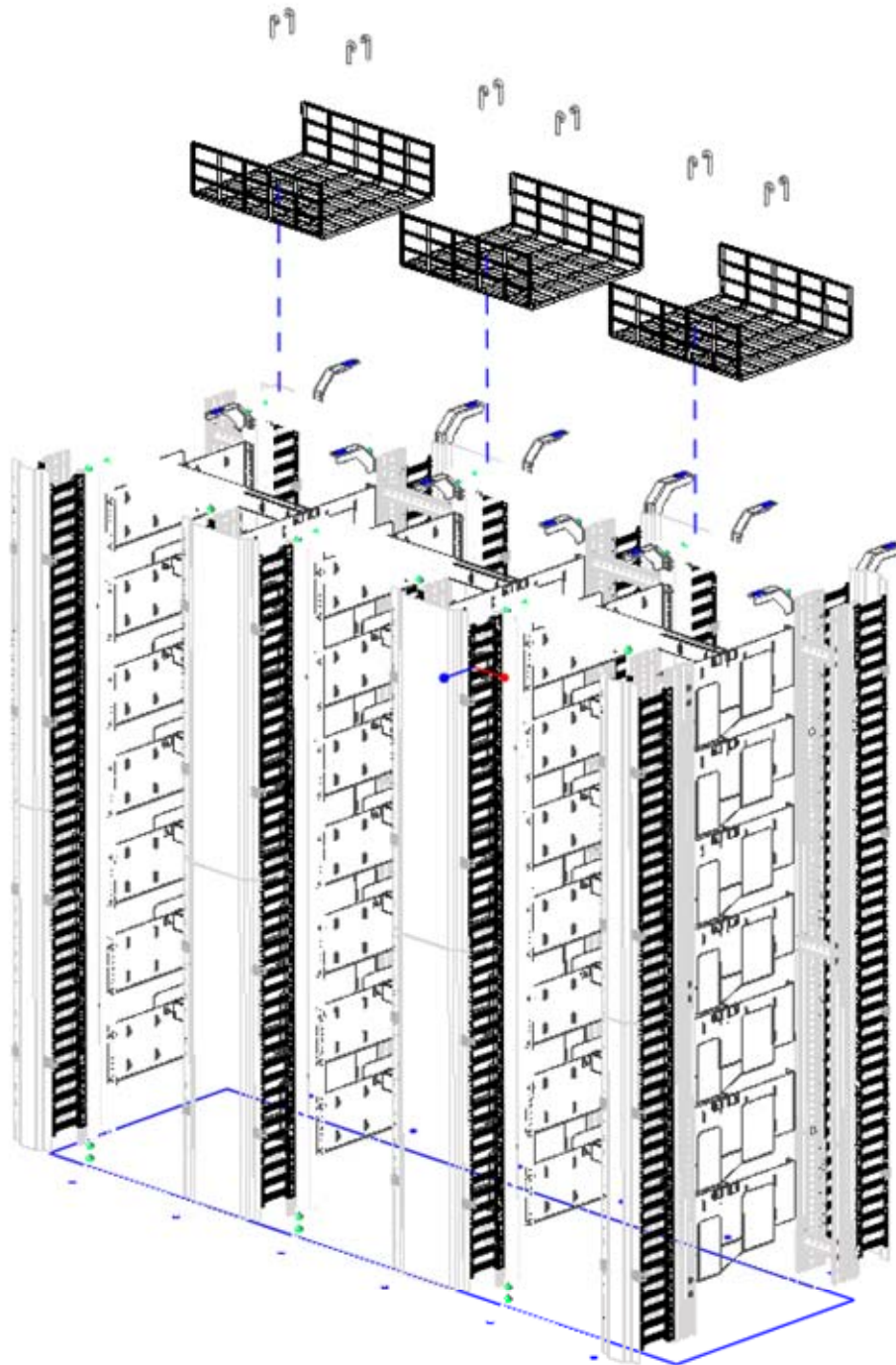

D) Cabel management

Step 1:

- Dress each cable bundle (96 cable/ bundel) and tie them at each trough

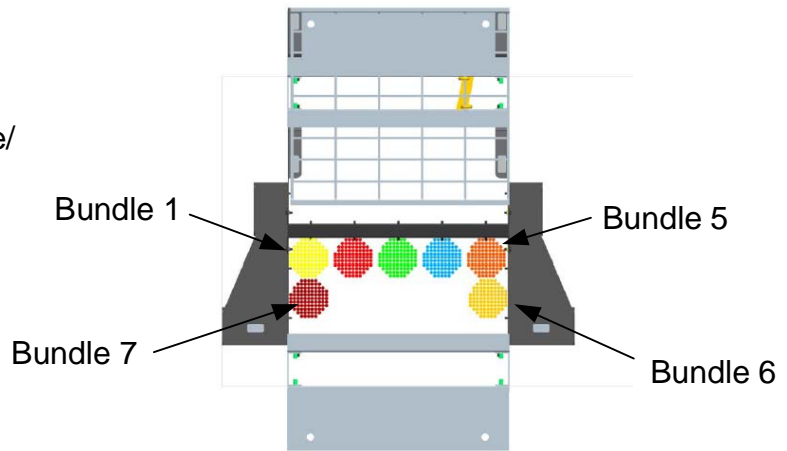

OVERHEAD KIT

Overhead kit is reserved to manage cross-connect cables only.

CABLE LENGTH

Bundels shown at tie point.

Make sure to keep required slack to terminate connections

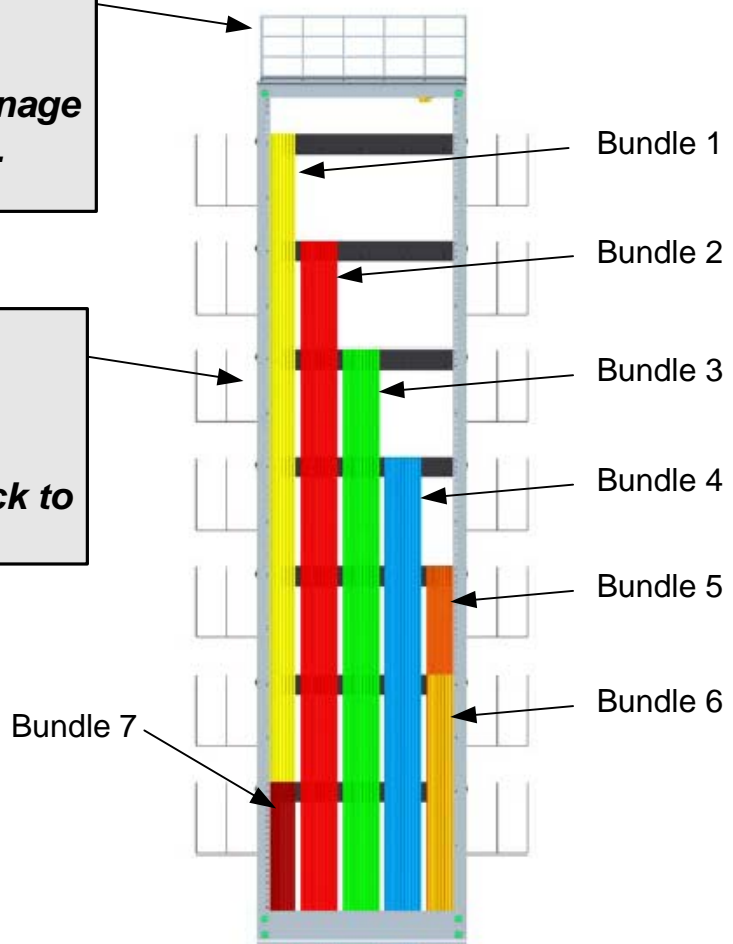

E) Cross-Connect Management

Option 1: Same rack, same half

- Rout cross-connect cable from front to back across trough
- Change level in hatched area if required

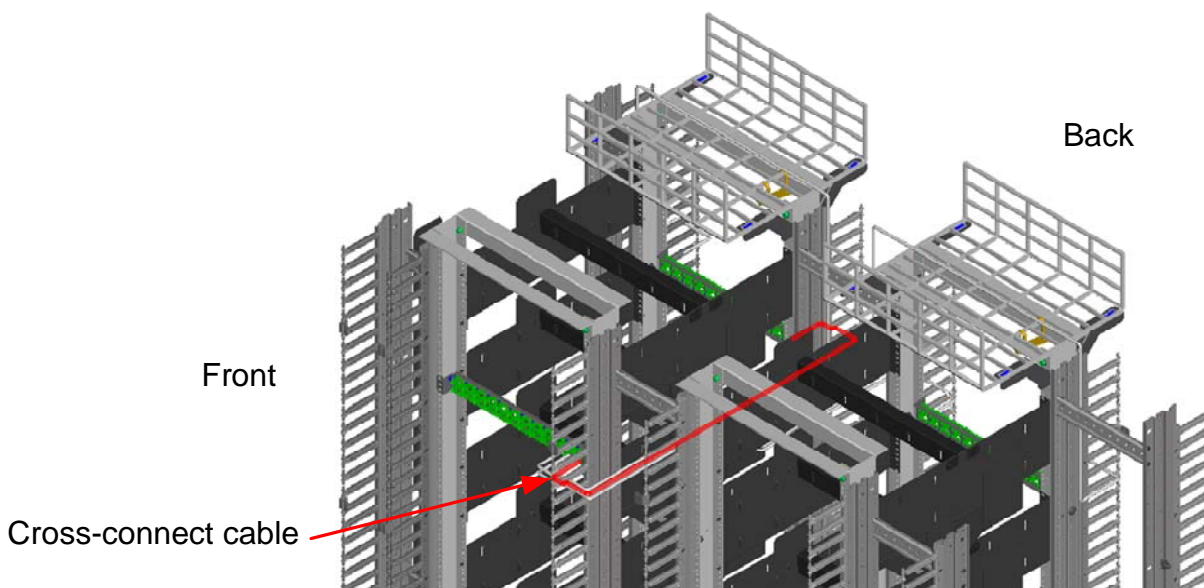
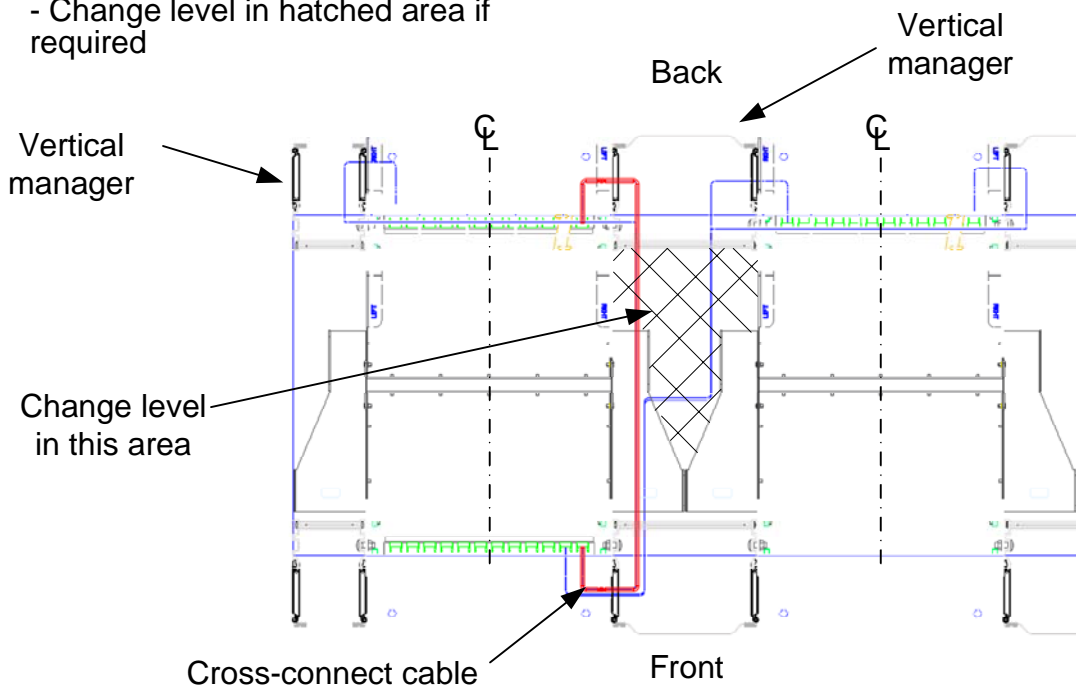

Option 2: Next rack, adjacent half

- Rout cross-connect cable from front to back across trough
- Change level in hatched area if required

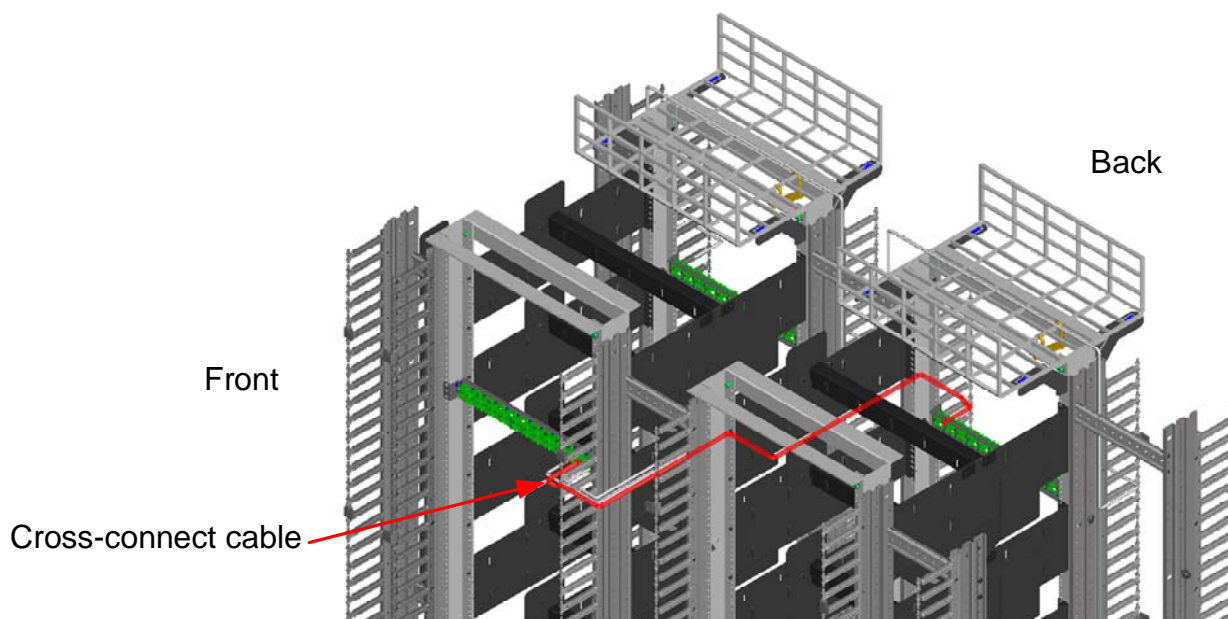
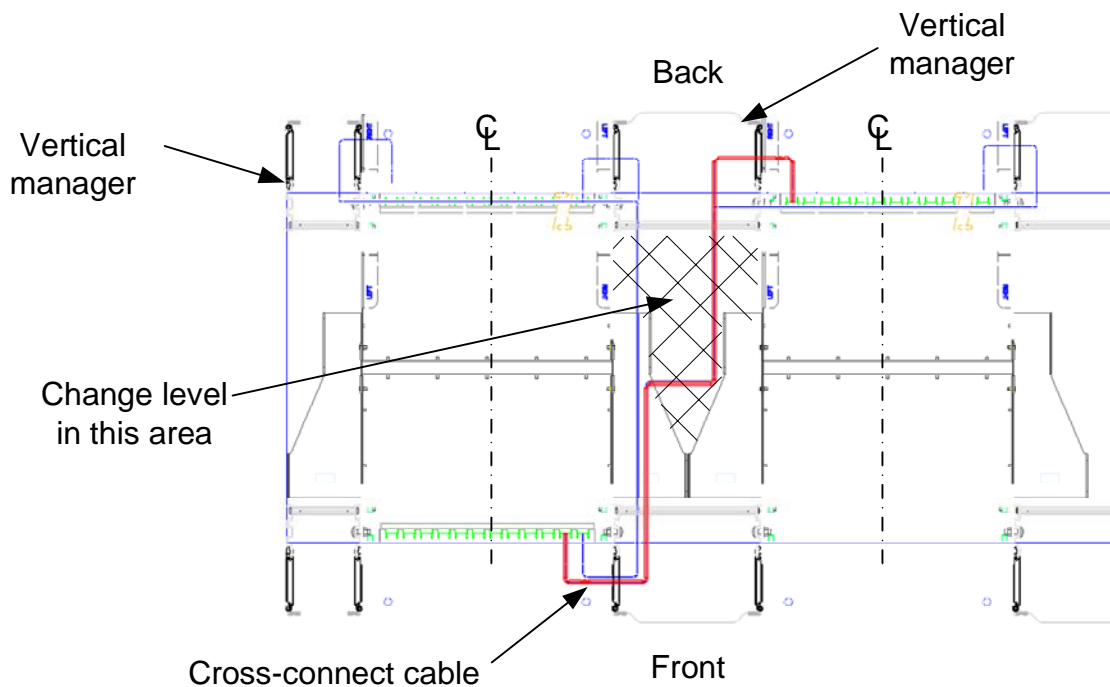

Option 3: Same rack, next half

- Rout cross-connect cable from front to back across trough
- Rout through overhead kit to reach next half
- Change level in hatched area

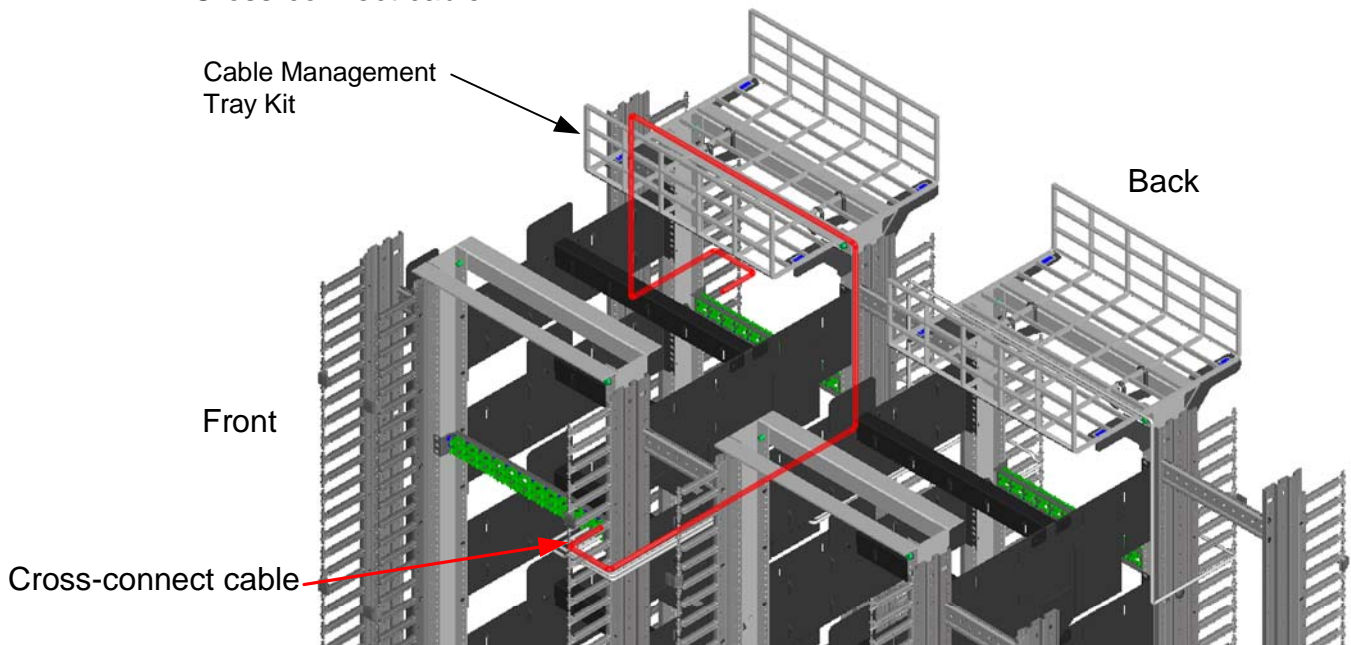
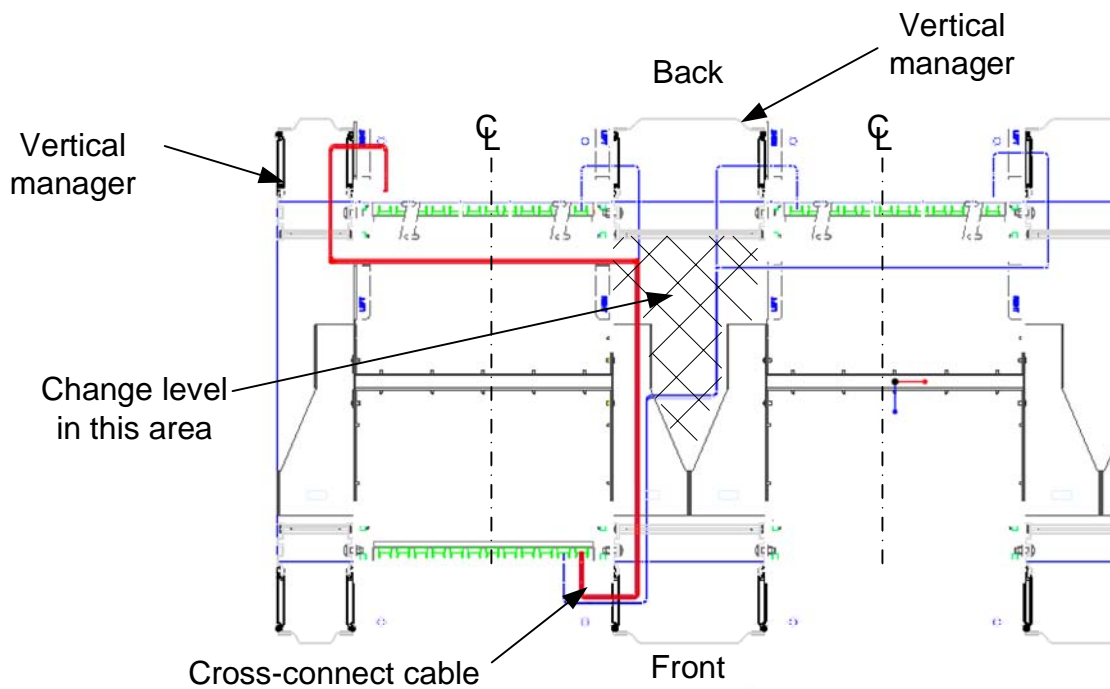

Option 4: Any next rack, any next half

- Rout cross-connect cable from front to back across trough
- Rout through overhead kit to reach next half
- Change level in hatched area

